

2 Doz Cookies

Sept. 1982

Edited by
B'nai Shalom
2496 E. Charros Rd.
Sandy, Utah 84092

the Shofar



PRESIDENT'S MESSAGE

As we all know, the Church respects the attitude of the Israeli government regarding the missionary activities in that land. From time to time representatives of the Church have been called to visit Israel to gain a greater understanding of the people and to create a friendly atmosphere for the exchange of cultural ideas. However, proselyting has deliberately not been promoted. This has caused many Latter-day Saints to wonder how and when will our Jewish cousins have the opportunity to hear about a loving God who speaks through living prophets in our day and age.

Undoubtedly, the Lord has many ways to accomplish His work, but one of the most exciting examples is what is currently taking place on Temple Square in Salt Lake City. For the past two years, there has been an enormous influx of Israeli visitors. During the months of June and July of 1981, seven thousand Hebrew tracts of Joseph Smith's testimony were given to Jewish visitors on Temple Square. Early in August, the supply of the tract ran out, but the Israelis continued to arrive by busloads. These visitors were among the most attentive guests ever to visit Temple Square.

Those who did not speak English usually had one in their group to interpret. The LDS hosts, hostesses, and tour guides were delighted with the cordiality and intelligent curiosity displayed by their fellow Israelites. Among the visitors were doctors, educators, government officials, and many great just-plain, everyday people. Most of the visitors remarked that on Temple Square they had received more considerate treatment and friendly attention than anywhere else in the United States. Some even said that, "The Mormons seemed more concerned about them than did many of their fellow Jewish hosts in the U.S." The Latter-day message about a God who lives, speaks, and who really cares about his children brought tears to many Israeli eyes.

This summer, because of the Lebanese war, the volunteers on Temple Square anticipated a very sparse Jewish representation. Much to everyone's surprise, the Israeli busloads continued to arrive; and again the supply of Joseph Smith testimony tracts were exhausted long before the number of guests began to diminish. Needless to say, Temple Square can use more Hebrew speaking volunteer guides. Any qualified parties can call President Sontag at 801-531-2534 in Salt Lake City.

We will keep you informed of this unusual Israeli "migration" in future Shofar editions.

SHALOM!!

DID YOU KNOW

HEBREW WAS ONCE CONSIDERED FOR THE OFFICIAL LANGUAGE OF THE UNITED STATES OF AMERICA?

Shortly after the declaration of independence and the ensuing war with the British, feelings in America were somewhat bitter. A move to develop an American language that was different from English gained momentum. Because of its universality, the language most considered was Hebrew.

Had it been adopted, you and your children would all know Hebrew and English would have to be studied as a second language.

Any of you who are interested in studying Hebrew more seriously as a second language can gain instruction from qualified teachers at the Jewish Community Center. Classes will start on Wednesday evenings at 7 p.m. September 27 through November 17. Beginners classes are from 7-8 and intermediate classes are from 8-9. Fees for member of the Center are \$20 and \$30 for non-members.

The classes are a lot of fun! Add a new dimension to your life. Learn Hebrew!

OUR GENEALOGIES

Jewish family names are usually found in one of the six following categories:

1. Place names 2. Kin names 3. Rank names 4. Occupation names 5. Descriptive names 6. Derisive names.

Examples of Place names are: Vilner (Vilna, Poland), (Kaidan, Lithuania), Kurland (Latvia), Barr (Russia), Warshavsky (Warsaw, Poland).

Jewish kin names are usually the father's name with the Russian suffix -- "Ovitz", meaning "son of". Davidovitz is equivalent to Davidson. Rabinowitz--Rabbi's son. Hirshkowitz -- Hirske's son. Occasionally family names were based on the name of the mother. This occurred not only when the mother was widowed, but also in cases where the mother was more prominent than the father. Sometimes, even the husband was called by his wife's name for the above reason. Names like Rivkas, Neches, Beiles are examples. Names ending in s were either after a mother or wife.

Occupation names include examples like Kirzner (hat maker), Resnick (kosher slaughterer), Mekler (salesman), Stoller (carpenter).

Rank names are exemplified by Cohen, Kaplan (Chaplain), Kahan, Kagan, Kahane, all of which denote membership in the priestly lineage of Aaron. The names Levi, Levin, Levitan, Levinson and Levinsky belong to the family of Levi. The name Segal is derived from (Sgan Levi-- Officer of the Levites). The Cohens and the Levys are the most aristocratic family names.

Descriptive names are those such as Weiss (white-fair), Schwartz (black-swarthy), Klein (little), Gross (big), Graber (thick, heavy), Geller (yellow-blond), Sussman (sweet man), Klugman (wise man), Kurtz (short).

Derisive names were given to the Jews by their antagonists and include names such as Ochs (ox), Mehlwurm (flour worm), and Meisel (mouse). Many times the Jews would frustrate their detractors by making these families the most influential.

SHALOM!!!

B'NAI SHALOM ACTIVITIES

During our semi-annual meeting last April, several new B'Nai Shalom officers were installed. Included was a new 1st Vice President, Sister Sylvia Linford; a new Secretary-Treasurer Brother Ron Nielsen; and a new Shofar editor Sister Theda Butt.

A vote of thanks was given to the following retiring officers: Sister Jolene Keeley, former Shofar editor; Sister Gail Boyd, former Secretary; Brother Albert Ostraff, former 1st Vice President; and Brother Ron Nielsen, former Treasurer (and newly elected Secretary-Treasurer).

Also, during the meeting, the newly condensed and simplified B'Nai Shalom Constitution and By-laws were ratified by those present.

Brother Roland R. Wright, former President of the New York, N.Y. Mission, was our guest speaker. He gave an inspirational and instructive report on how to organize the Jewish proselyting program in the mission field. He said the most important factors in his success were the brief preliminary training on Jewish proselyting he had received prior to departing for the mission field, and the need to explain to the missionaries the great significance of teaching the Jewish people. He indicated that once the mission president the the missionaries caught the vision of bringing the Gospel to the Lord's own people, the required enthusiasm was automatic and almost overwhelming.

Inclement weather reduced attendance at the meeting, but the Spirit was in abundance. As usual, refreshments were spectacular!!

We would especially like to thank everyone who helped or participated in any way.



G O R M E T C O O K I N G

"Blintzes" are traditionally a Jewish dish. They are made with hoop-cheese which is not available at stores in Salt Lake. Some people, and some recipes, call for dry or regular cottage cheese. None of these products are as delicious as cream cheese. This recipe was developed by Ruth Glick.

Blintz shell or Crepe:

This recipe can be used in any dish calling for crepes. Serves 10 for 1 blintz each.

- 2 eggs
- 2 T. salad oil
- 1 c. milk
- 2 T. sugar
- 3/4 c. sifted flour
- 1/2 t. salt

Method: Mix with beater or by hand until well blended. Drop about 3 T. onto a hot buttered 10" fry pan or crepe pan. Roll pan until batter is spread evenly on bottom of pan. Cook for about one minute until lightly browned. Drop out on clean dish towel. Do not cook other side.

Filling: 2 large cream cheese. Soften at room temperature. Mix in electric mixer until smooth. Add: 1 egg, 1/2 t. vanilla, and 2 T. sugar. Mix until smooth. Can make it ahead and refrigerate. Fills 15-20 shells.

HOW TO DO IT:

Take one of the shells (browned side up) and put about 2-3 T. of filling on edge of shell. Roll over once. Fold in sides, and roll the rest of the way as a jelly roll. Fry in buttered pan seam side down until browned. Turn and brown on all sides.

Serve hot. You can make a few hours ahead and warm in the oven. Serve with a dollop of sour cream and fruit sauce or preserves.

NOTES FOR SHELL:

Can be filled with chicken and served with a clear chicken sauce. Can be used for swedish pancakes.

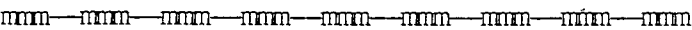

MEET SYLVIA LINFORD, 1ST VICE-PRESIDENT

B'nai Shalom's first woman vice-president and a former secretary, Sylvia is a native Brooklynite from a staunch Jewish background. Baptized in 1950, she is the mother of four children and, with her husband Noel, now resides in Sandy, Utah.

MEET RON NEILSEN, SECRETARY-TREASURER

Ron's been a great treasurer and now the office is combined with the secretary. We welcome him back as an officer.

Ron's occupation is a salesman for Beneficial Life Insurance Company. His avocation is being a father to his eight children. He and Margie have 6 boys sandwiched between their oldest daughter, Heidi who is nearing 17, and their youngest daughter Catherine, who is 2 years old.

The boys in the sandwich are David, Daniel, Michael, Jared, Jacob, and Joseph.

Ron and Margie were in the process of moving to Farmington, Utah, when I called to get information from them, and it becomes very hectic on moving day even if one doesn't have such a grand family to move.

WANTED: NEWSWORTHY ITEMS FOR THE SHOFAR

This is your newsletter and its purpose is to inform you of the latest things that concern members of B'Nai Shalom.

Your editor would appreciate any insight as to articles that might work. The more input you have into the newsletter, the more it will be what you desire. You can call me at (801) 524-5403 during the day or at home 943-8320 if you have anything you suspect would make good print.

After all, you elected me to this office; now I need the support you voted to give me. Thank you all. My address is 2835 Coventry Lane, SLC, UT 84121.

Theda Butt

MEET THEDA BUTT, YOUR SHOFAR EDITOR

Your President asked me to tell some things about me to help you get acquainted with me. My Grandfather, Alexander Neibaur, was the first Jew to join the Church in 1838 in Preston, England. His son-in-law, David Rosenbaum, later became the second one.

I was born in Wyoming but have lived in Salt Lake City since 1954. LaVell Butt is my husband and we have 3 sons, 1 daughter, and 1 grandson, so far.

I love writing and have some poetry and some articles published, and look forward to serving you on the Shofar.

GUEST SPEAKERS ARE ANNOUNCED FOR OUR FALL N'NAI SHALOM MEETING ON SEPTEMBER 30, 1982

Brother Wayne and Sister LuRee Ottley, recently returned from Israel as Church Representatives will give a special report at our semi-annual meeting at 7:30 p.m. on September 30, 1982. Other speakers and musical numbers are also being arranged. We need you in attendance so that it will be as great as other meetings in the past.

The meeting location is again in the Crescent 18th Ward chapel located at 2135 East Pepperwood Drive (10900 South). Do you remember that street that had so much snow last spring that vehicles had a difficult time maneuvering on it? It was heartening to see the Christ-like attitude of fellow B'Nai Shalom members who transported people and cars up that slick street last April. Thanks to all of you who were able to negotiate the hill and those who assisted others to do so.

This meeting should not have that snowy problem. A map below shows how to get to the chapel, sans snow. Plan to join us September 30 at 7:30 p.m. for another inspirational meeting.

SHALOM!

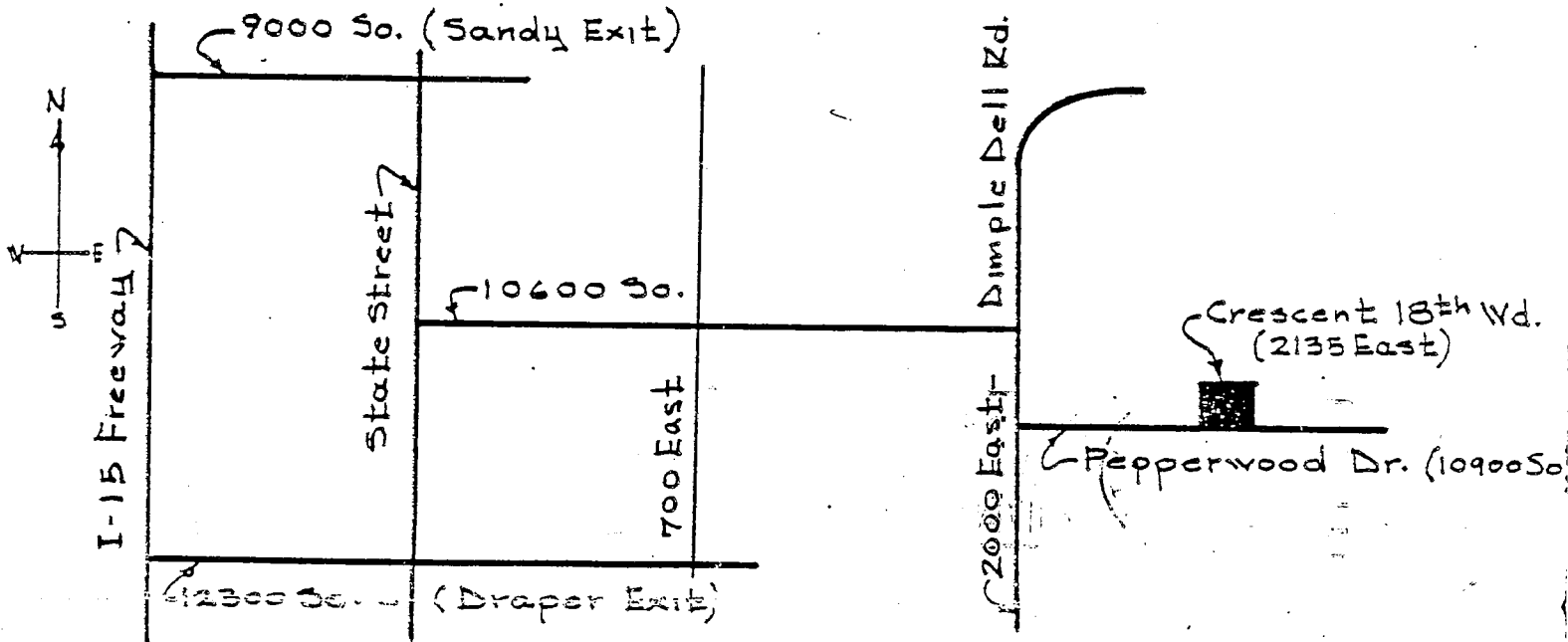

Theda Butt, Editor
2835 Coventry Lane
Salt Lake City, Utah 84121



FIRST CLASS MAIL

ELISSA MOLLING
328 North 1120 West
PROVO, UT 84601