

Call Bro

Sept. 1983

Edited by  
B'nai Shalom  
9445 Dolomite Dr.  
Sandy, UT 84070

# the Shofar

הַשּׁוֹפָר

## PRESIDENT'S MESSAGE

### B'Nai Shalom - Children of Peace

We are now living in the days foretold by our prophets in ancient and latter-day scriptures. In a world torn by wars and rumors of war, troubled with alarming increases in natural catastrophes and surrounded more than ever by evil influences, we must fortify ourselves by putting on the armour of God.

President Harold B. Lee, in his closing remarks at the October 1973 Semi-Annual Conference, said, "Peace by with you, not the peace that comes from legislation in the halls of Congress, but the peace that comes in the way that the Master said, by overcoming all things of the world."

As members of B'Nai Shalom, let us truly be the Children of Peace.

Sylvia Linford

\* \* \* \* \*

### B'NAI SHALOM (CHILDREN OF PEACE)

Membership is open to all members of The Church of Jesus Christ of Latter-Day Saints interested in promoting the objectives of the organization, whether or not such persons are of Jewish ancestry.

Objectives of this organization shall be carried on within the framework of existing LDS programs, and are as follows:

- A. To promote the faith and activity of Jewish members of the Church.
- B. To encourage genealogical work by persons of Jewish descent, and to develop, with the guidance and assistance of the Genealogical Society, a program which will assist members in solving problems of research peculiar to Jewish heritage.
- C. To promote greater understanding of Jewish culture, traditions, and attitudes through an organized educational program to the general membership of the Church.
- D. To offer assistance in all authorized LDS Church programs oriented towards Jewish people.

## JOHN TVEDTNES' AGREES TO BE THE SPEAKER AT THE SEMI-ANNUAL MEETING OF B'NAI SHALOM IN SEPTEMBER

Thursday, September 29, 1983, is the date set for the semi-annual meeting of B'Nai Shalom. John Tvedtnes has consented to come as the guest speaker. The meeting place is the Sandy 27th Ward located at 9501 Poppy Lane in Sandy. Meeting time is 7:30 p.m.

John is a convert to the Church and has served both a full-time and a stake mission. He has been teaching at either BYU or the University of Utah for the past 15 years. He and his family spent 8½ years in Israel where he taught at the BYU Center and served as a tour guide. He also served in the Jerusalem Branch Presidency.

John has four degrees, all centered around cultures of the Near East and has authored three books. The B'Nai Shalom organization is proud to have him as our guest speaker and know you will enjoy hearing him.

SEPTEMBER 29, 1983 7:30 p.m. SANDY 27th WARD 9501 POPPY LANE, SANDY

B'NAI SHALOM, cont.

- E. To engage in other activities deemed appropriate in carrying out objectives of the organization.
- F. To be a resource to Church members in giving information of Jewish people.

\*\*\*\*\*

MEET JERRY KIDD

Jerry is a "good-looking", congenial man who is involved in the communications field. He owns Orien Printing Company and has an interesting historical background.

Jerry's father and grandfather are both Jewish immigrants to America. His grandfather, Irving Alexander, sold timber in Kentucky. He dreamed about two men in black coats who had a message for him and he was supposed to listen to that message.

When the missionaries from The Church of Jesus Christ of Latter-day Saints came to his home, in black coats, his grandfather recognized them and did listen to their message and did join the Church.

As a consequence of this, the grandfather was disinherited by his family. Through the years, the family has become more friendly, even though they are still somewhat aloof.

Jerry and his wife, the former Jean Nee McQueen, have eight girls and one son, David. Jerry is a Vice-President of the B'Nai Shalom organization.

\* \* \* \* \*

Plutarch, the great Greek moralist and biographer, spent his years writing about the lives of men, good and bad. He said:

It was for the sake of others that I first commenced writing biographies, but I find myself proceeding and devoting myself to this study for my own sake. The virtues of these great men serve as a sort of looking glass into which I may see how to adjust and adorn my own life. I am thus enabled to receive and retain images of the best and worthiest characters and also to free myself from any ignoble, base, or vicious traits.

Every seeker after success would do well to look into the looking-glass of other great people and retain images of the best and worthiest characters as an example in their lives.

MEET MAX YOSPE

Max is a former president of B'Nai Shalom and is currently Vice-President of the organization. He served with Harry Glick and Dave Wyner in the presidency several years ago.

Max is Jewish, was born in Chicago and has lived in Los Angeles. He came to Utah in charge of a military police town patrol in Tooele, met his wife, the former Elaine Gillespie, and converted to The Church of Jesus Christ of Latter-day Saints in 1945. After his discharge in January 1946, they stayed in Tooele.

Max retired from the Salt Lake City Police Department after 32½ years of service. He spent 5 years as the Assistant Chief of Police in Tooele.

The last 6 years on the force were spent as police chaplain at the request of the other officers, being assigned to the position by the Church headquarters. In this position, he guided 27 ministers of various faiths in helping inform the public whenever any traumatic situations arose. He was on call 24 hours each day if a death or other tragedy occurred.

After retirement, Max contracted with the city to work part-time as a chaplain on a volunteer basis.

Max has the honor of being the first Jewish bishop in the Church and served 8 years in this capacity. He has held many leadership positions since his conversion. He has spent 18 years teaching in various classes.

Max and Elaine have 13 grandchildren and their 3 children are Sue Ann, Clark, and Lorraine.

\* \* \* \* \*

I looked at my brother through the microscope of hate,  
And I said, "How mean my brother is."  
I looked at my brother through the telescope of scorn,  
And I said, "How small my brother is."  
Then I looked at my brother through the mirror of truth  
And said, "How like me my brother is."

Anonymous

IN LOVING MEMORY

RUTH ELAINE ADAMS GLICK

Born: September 4, 1925, in Los Angeles, California  
to Clarence and Ruth Adams  
Married: Harry Louis Glick on September 21, 1947  
Died: August 27, 1983, in Salt Lake City, Utah

Ruth is survived by her husband, Harry who is the immediate past President of B'Nai Shalom, and by her three sons, Steven P, George D, and Kenneth D. Glick and her two daughters, Barbara Glick Mason and Lori Glick Scheer.

Ruth graduated from the Chovinard Art Institute in California and was a former layout artist and art director for ZCMI in the advertising department. She was a professional free-lance artist and received multiple art awards. She served in community art organizations and was an art instructor for many years.

Ruth was an ordinance worker in the Salt Lake LDS Temple as well as a former Relief Society president, YWMIA president, and a genealogy instructor. She was given the Silver Bee Award in scouting.

WELL DONE; THOU GOOD AND FAITHFUL SERVANT. ENTER INTO THE JOY OF THE LORD!

\* \* \* \* \*

JERUSALEM DIG UNCOVERS WALL OF CITADEL

Reprinted from the Salt Lake Tribune

Archaeologists digging through the roots of Jerusalem's history this summer uncovered the massive foundation wall of a Canaanite citadel, and reached the earliest layer of a city and civilization more than 5,000 years old.

Yigal Shiloh, head of the team excavating the City of David, told reporters Monday that a fortress built by King David was constructed on top of the even larger stronghold that he captured around 1,000 B.C.

After 6 years of digging, Shiloh's team has exposed 25 layers of civilization which, like snapshots in an album, give a glimpse into the daily life of Jerusalem through history.

"We are not trying to prove or disprove the Bible," said Shiloh of the Hebrew University of Jerusalem. "We are looking for the whole story and the cultures of all periods, including the Biblical period."

But some of the finds add physical evidence to events described in the Bible.

Bare-breasted fertility dolls of Isrelite times were found in huge quantities. "We were not surprised. We can read in the Prophets that they were fighting against idolatry all the time," Shiloh said.

An insight into ancient Jerusalem's commercial ties came from charred fragments of boxwood from northern Syria or southern Turkey that could have been part of a decoratively carved piece of furniture.

Shiloh said scientific tests showed that the blackened fragments were probably from furniture burned when the Babylonians razed Jerusalem in 586 B.C., and destroyed the temple built by King Solomon 400 years earlier.

The Canaanite city that David seized was built on the western slope of the Kidron Valley. The archaeological site is just a few hundred yards from the northeast corner of the 16th century wall of the Old City and will be incorporated in an archaeological garden.

cont.

The earliest structures built lower on the slope go back to 3200 B.C., when the tribes of the Judean mountains first began gathering into cities. As Jerusalem, then known as Jebus, developed, it moved up from the valley floor.

Nothing remained of the fortress that David built on the hilltop, except a retaining wall that has the stepstone appearance of the side of a pyramid. This year Shiloh sliced through one section to expose the wall of the earlier citadel.

Shiloh said the dig continued unhindered this year despite mounting religious controversy.

Ultra-Orthodox Jews say the excavations intrude on a medieval Jewish graveyard and desecrate the sanctity of the dead.

The following people have paid their dues through April:

- Theda Butt
- Richard & Carol Evans
- Jean A. Ellsey
- Harry Glick
- Kaye Healey
- Jolene Keeley
- Jay & Patty Karsevar
- Elliott & Zona Landau
- Joseph & Sylvia Linford
- Haws A. Marble
- Gordon & Ella McGavin
- Ronald & Margie Nielsen
- David Novak
- Wayne & LuRee Ottley
- Moses & Betty Samowitz
- Sharon Turman
- David E. Wyner
- Max & Elaine Yospe

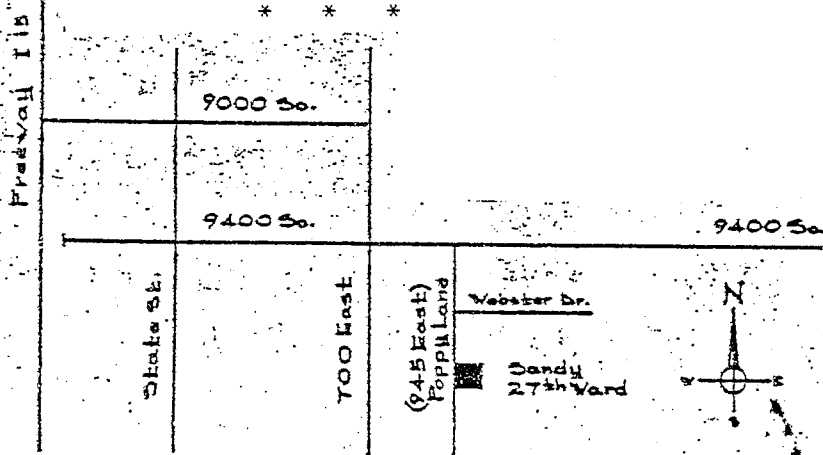

All others need to send in their annual dues or pay them at the next meeting in order to receive The Shofar and notification of our semi-annual meetings. The dues are \$6 per family or \$4 per individual. Please make your check payable to B'Nai Shalom.

Name \_\_\_\_\_  
 Address \_\_\_\_\_  
 \_\_\_\_\_  
 Phone \_\_\_\_\_

Theda Butt  
 5265 Gravenstein Park  
 Murray, UT 84107

FIRST CLASS MAIL

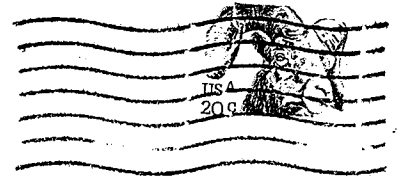

*Elissa Molleng*  
 338 North 1120 West  
 Provo, Utah  
 84601